

Capacity (25°C)	20HR (10.6A, 5.25V) = 212.0AH 10HR (20.5A, 5.25V) = 205.0AH 5HR (35.0A, 5.25V) = 175.0AH 1HR (138.0A, 4.5V) = 138.0AH
Operating Temperature Range	Charge = -15°C to +50°C Discharge = -20°C to +60°C Storage = -20°C to +60°C
Approx. Weight	28.0kg
Internal Resistance	Fully charged at 25°C : ≤ 2.5mΩ
Self Discharge	2% per month at (25°C)
Capacity Affected by Temp. (20HR)	40°C = 102% 25°C = 100% 0°C = 85% -15°C = 65%
Charge Voltage (25°C)	Cycle Use = 7.20-7.35V (-30mV/°C) Max Current = 60A Float Use = 6.75-6.90V (-20mV/°C)
Dimensions (Nominal)	Length: 306mm (12.0 in.) Width: 169mm (6.65 in.) Height: 220mm (8.66 in.) Total Height: 227mm (8.94 in.)

- Completely sealed, maintenance-free, low self-discharge
- State of the art AGM and grid alloy formula technology
- Non-spillable, stable quality and high reliability with excellent re-charging performance
- Floating and standby use up to: 8 years
- Cycle use: Up to 260 cycles at 100% DoD
- Cycle use: Up to 500 Cycles at 50% DoD
- Container and Cover Material – ABS UL94-HB (optional UL94-V0)
- Transportation - D.O.T., I.A.T.A. & F.A.A.



■ APPLICATIONS

Multipurpose	Alarm & Security System	DC Power Supply
Telecommunications	Comm. Power Supply	Auto Control System
UPS	Elec. Power System (EPS)	Traffic Control Signaling
Medical Equipment	Emergency Backup Power	Emergency Lighting

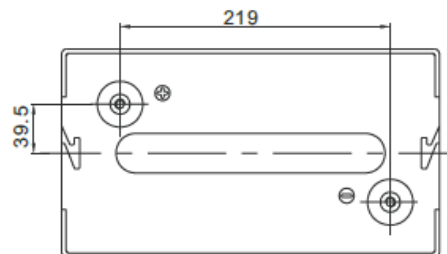
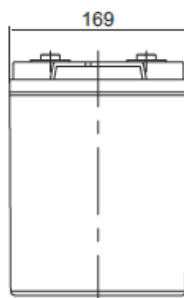
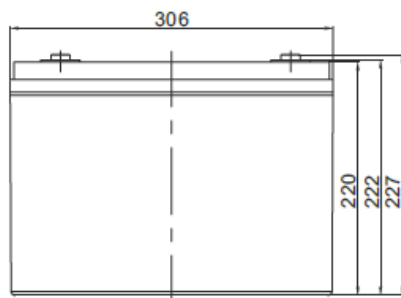

Terminal Type

■ Terminal M

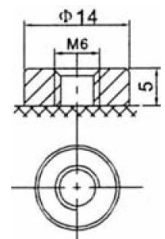

M6 Bolt

